

Selection diagram

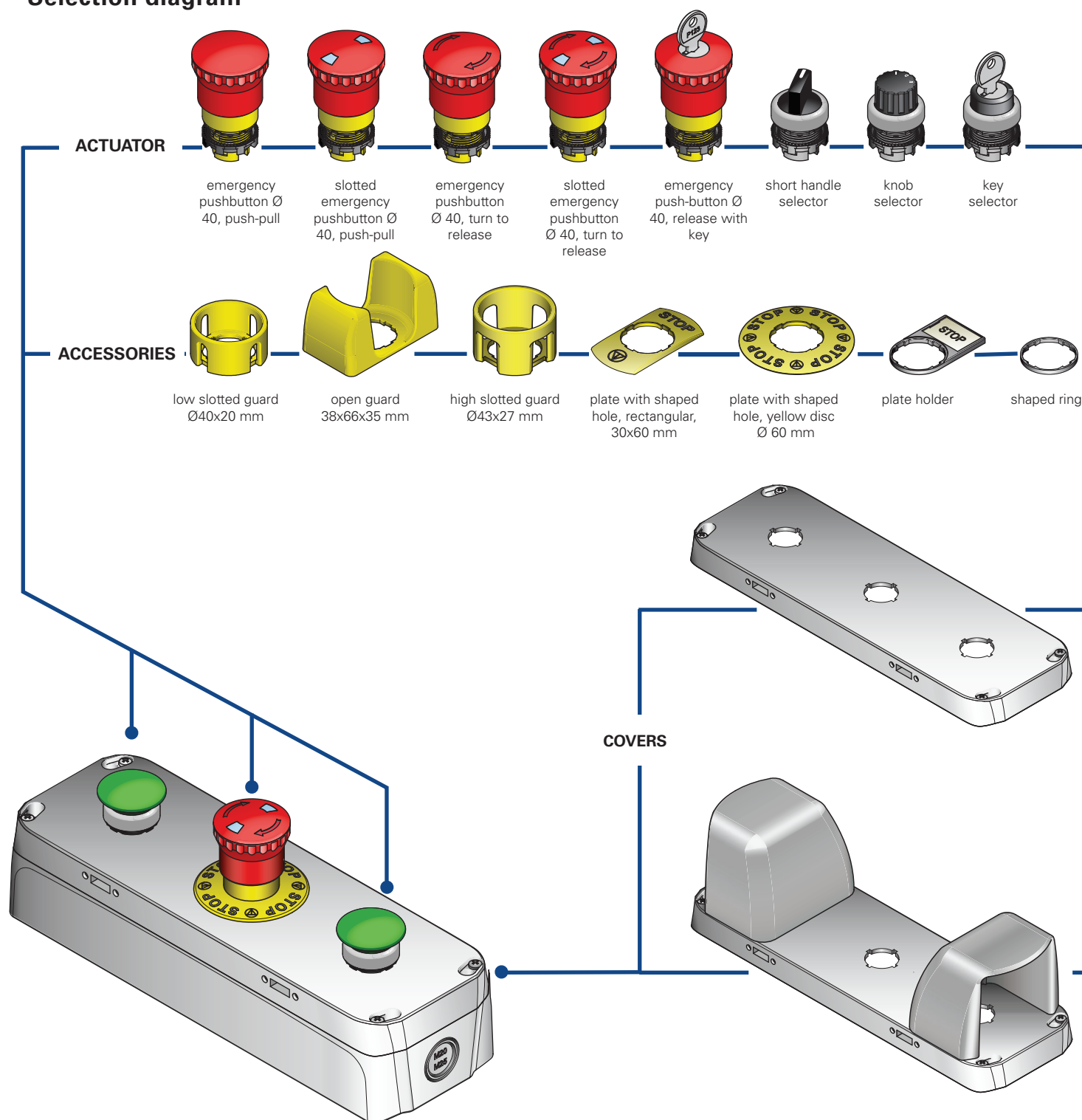

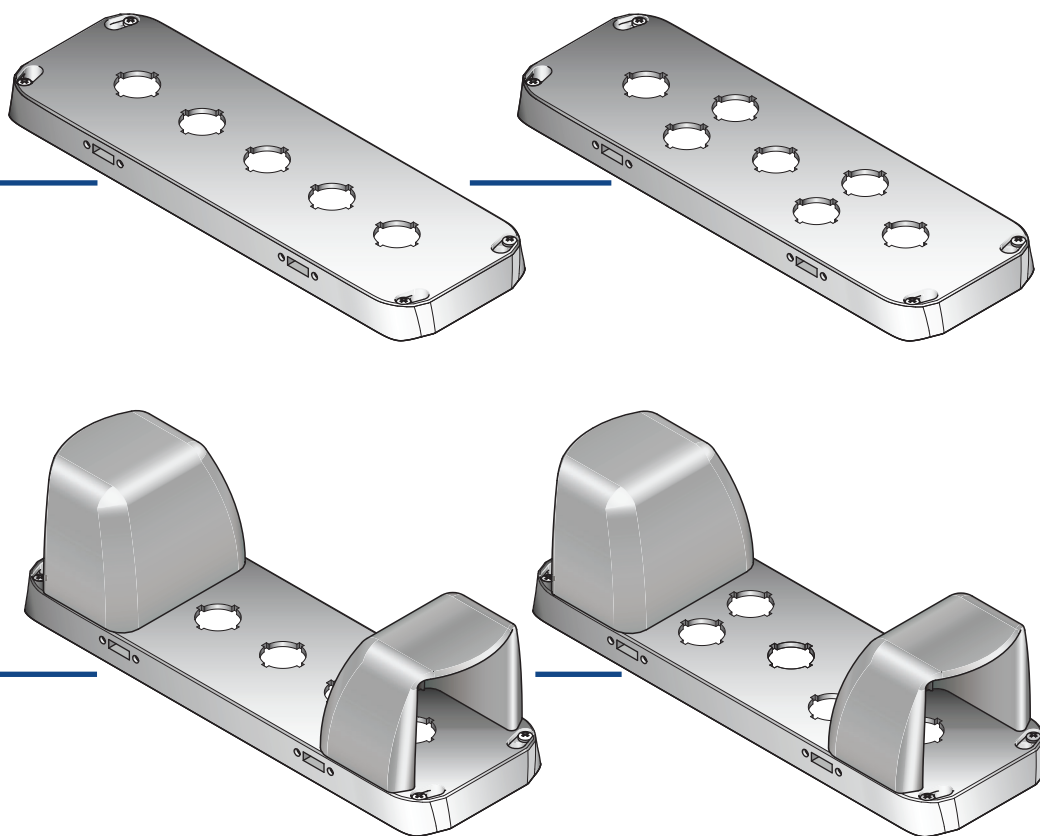
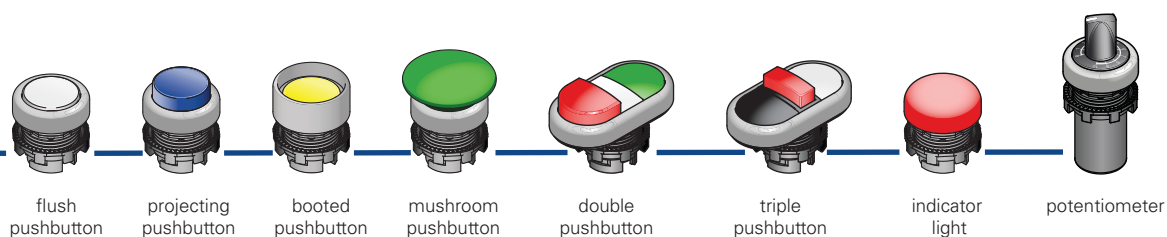

Enclosure code structure

EA 37010

Housing material

3 polycarbonate PC (standard)

Box dimensions

7 280x90 mm

Configuration

010 grey base, grey cover

... ..

Attention! The feasibility of a code number does not mean the effective availability of a product. Please contact our sales office.



- Main features**
- Protection degree IP67 and IP69K
 - Stainless steel retained screws
 - 2 lateral knock out conduit entries + 2 lower knock out conduit entries

Markings and quality marks:

CE

Technical data

Housing	
Material:	Shock-proof, self-extinguishing polymer with double insulation, UV resistant, fibreglass-reinforced material, high-impact resistance.
Screw material:	Stainless steel
Protection degree:	IP65 according to IEC 60529 with cable gland having equal or higher protection degree
Conduit entries:	2 lateral knock out conduit entries M20 - M25 -1/2 NPT 2 lower knock out conduit entries M20 - M25 -1/2 NPT
Devices assembling:	Suit for assembling with control and signalling Ø 22 mm devices.
Utilization requirements:	Ø 22 mm hole according to EN 60947-5-1 see page 3/98

For correct operation in compliance with the EN 574 standard, the bimanual controls must be connected to a CS DM ●●●●● safety module for a two-hand control device. See page 5/43.

General data

Ambient temperature:	-40°C +80°C
Cover screws driving torque:	1 ... 1,4 Nm

In conformity with standards:

IEC 60947-1, IEC 60947-5-1, EN 574, IEC 60204-1, EN 60947-1, EN 60947-5-1, EN 60204-1, UL 508, CSA 22-2 N°14.

In conformity with requirements requested by:

Low Voltage Directive 2006/95/EC, Machinery Directive 2006/42/EC and Electromagnetic Compatibility 2004/108/EC.

General characteristics

Fitting the EROUND boxes

The new EROUND line boxes by Pizzato Elettrica feature 4 additional holes in the cover, which make it possible to fit the boxes to a wall by inserting the screws through their external part, therefore without needing to open their cover to gain access to the holes. External fitting turns out to be particularly advantageous for prewired boxes.

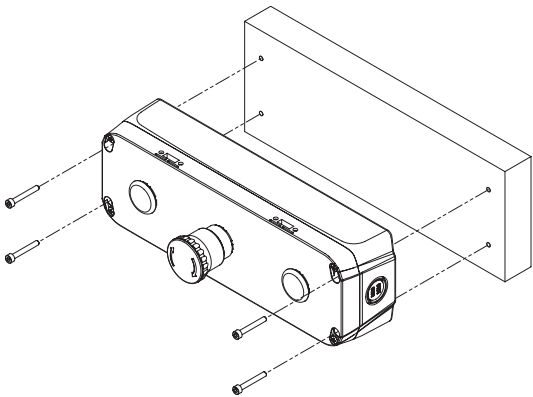

Wiring through the lower surface

The enclosures have 2 bottom conduit entries. They allow the wiring through the base leaving no wiring cables on view.

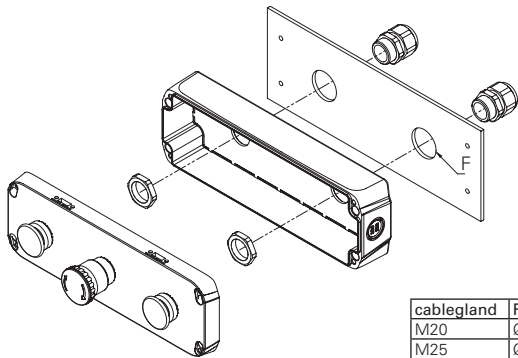

Enclosures selection table

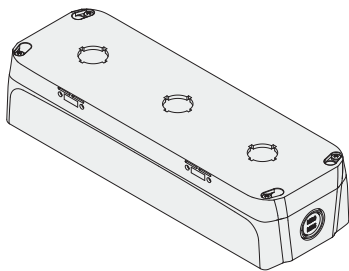

Colour	Article
<div></div> grey RAL 7035	EA 37014

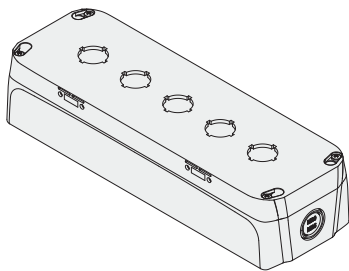

Colour	Article
<div></div> grey RAL 7035	EA 37010

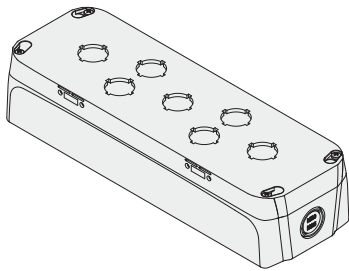

Colour	Article
<div></div> grey RAL 7035	EA 37012

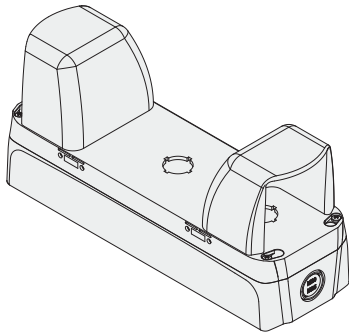

Colour	Article
<div></div> grey RAL 7035	EA 37015

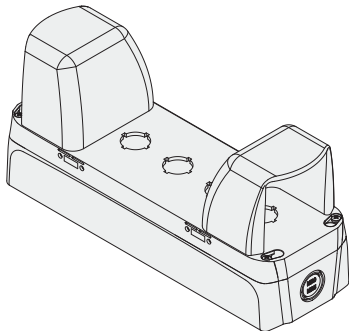

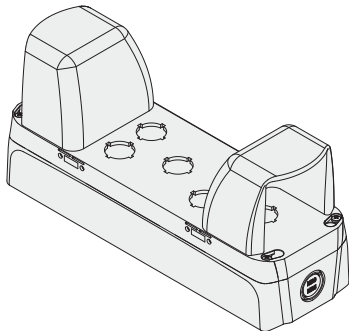

Colour	Article
<div></div> grey RAL 7035	EA 37011



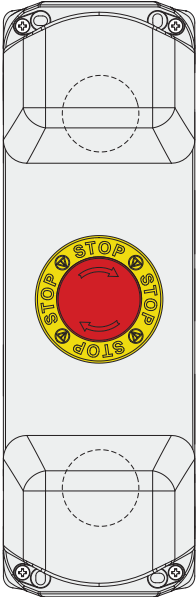

Colour	Article
<div></div> grey RAL 7035	EA 37013

Items with code on the **green** background are available in stock

Complete units with enclosures

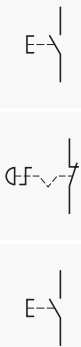
	EA AC37011			
				
	Description	Characteristics		
	Mushroom pushbutton - 1NO E2 1PU2F4490 Guard VE GG3AA9A Contacts 1x E2 CP10G2V1	spring-return, green		
	Emergency pushbutton Ø 40 - 1NC E2 1PERZ4531 Plate VE TF32A5109 Contacts 1x E2 CP01G2V1	pos 2 /	pos 3 1NO	pos 1 /

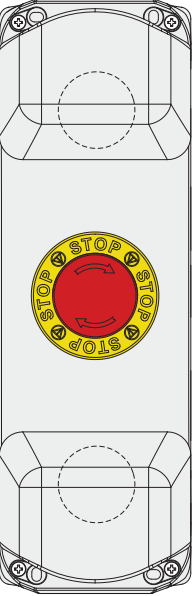

	EA AC37010			
				
	Description	Characteristics		
	Mushroom pushbutton - 1NO+1NC E2 1PU2F4490 Guard VE GG3AA9A Contacts E2 CP10G2V1 + E2 CP01G2V1	spring-return, green		
	Emergency pushbutton Ø 40 - 1NC E2 1PERZ4531 Plate VE TF32A5109 Contacts 1x E2 CP01G2V1	pos 2 /	pos 3 1NO	pos 1 1NC

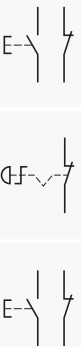

Dimensions

